

Issue/RevNo	Revision note	Date	Signature	Checked
1.0	Original Issue	14/12/2018	GHD	CHG

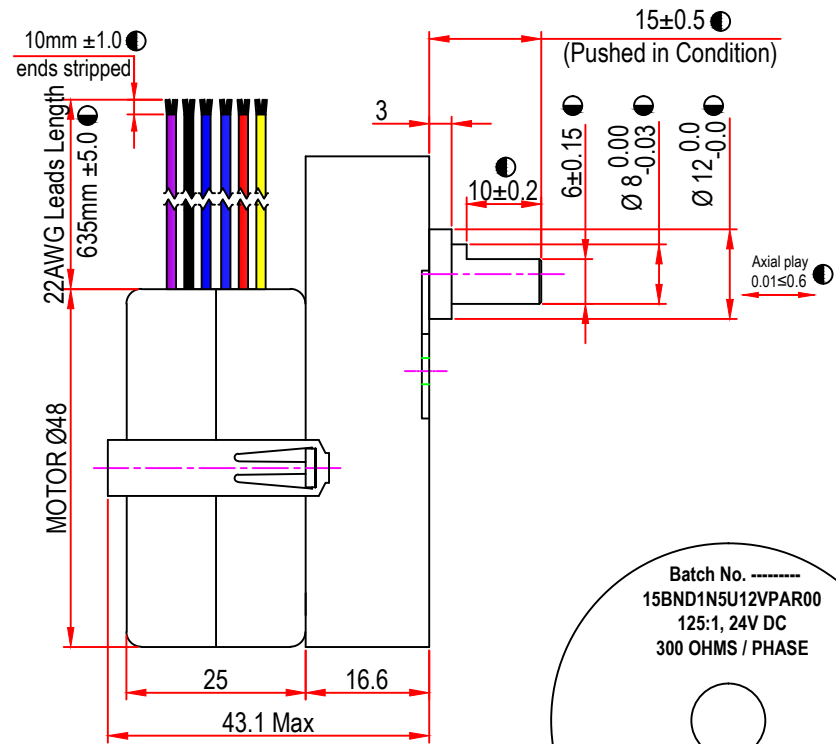
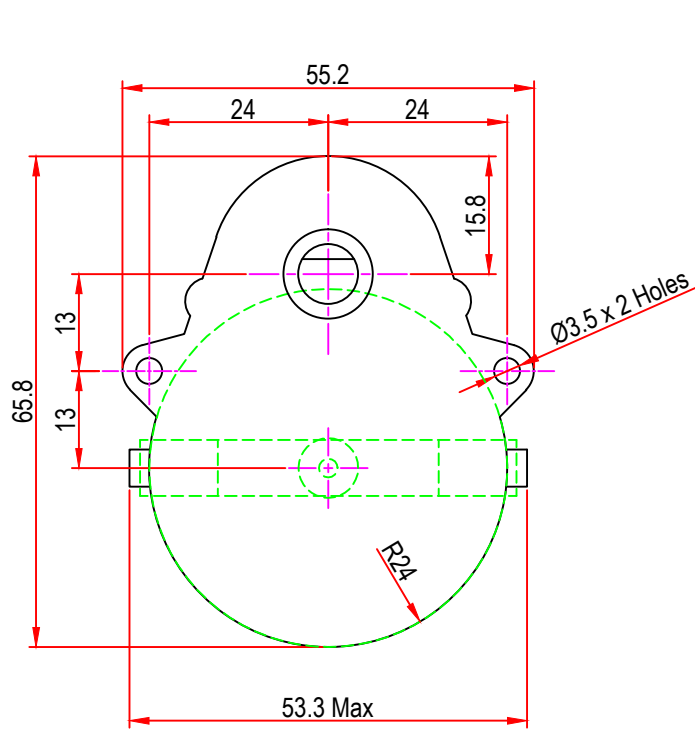

(Project : E-Mechtex)

Final Inspection Table

Sr. No.	Description	Method of Inspection	Acceptance Criteria
1	Supply Voltage	Test Bench	24V DC
2	Resistance (Ω) / Phase	Multimeter	300 Ohm/ phase
3	Duty Cycle	Description	100% /Blue/Yellow/Red/Black/Violet
4	O/P Direction from shaft end	Visual	Reversible
5	Reduction ratio	Visual	125:1
6	O/P Speed of Geared Motor	Watch	4 rpm @ pps
7	Noise Level	Sound Chamber	≤ 60 dB (A) measured at a distance of 100 mm in an anechoic chamber
8	Shaft Type	Vernier	PA type shaft (as per drg.)
9	Shaft Axial Play	Vernier	$0.01 \leq 0.6$ mm
10	Bush	Vernier	Brass Bush $\text{Ø}12 \times 3$ mm
11	Lead Position	Visual	Top
12	Flexible Wire Leads	Measuring Tape	22AWG, 635mm total included strip length of 10mm

Description :
MTSU55PHS6, 24V DC, 125:1 Ratio, 8x31.5TL shaft, with rivet nut M4



Motion Drivetronics Pvt Ltd

Itemref	Client	E-MECHTEX	Article No./Reference	
Designed by	Checked by	Approved by	Date	Scale
GHD	CHG	TNB	14/12/2018	do not scale
BRAND - MECHTEX		DRAWING CODE : 15BND1N5U12VPAR00		
Navi Mumbai - 400 709.		Assembly Drawing		Edition
				Sheet 1 of 1